

# LE PLATEAU

Class A logistics solutions in a prime location at Soissons/Ploisy in northern France



**From 6,000m<sup>2</sup>**

Your logistics hub in Europe



**Industrial Securities Europe**

YOUR PAN EUROPEAN LOGISTICS PARTNER



A GEOVIA LOGISTICS PLATFORM

# LE PLATEAU

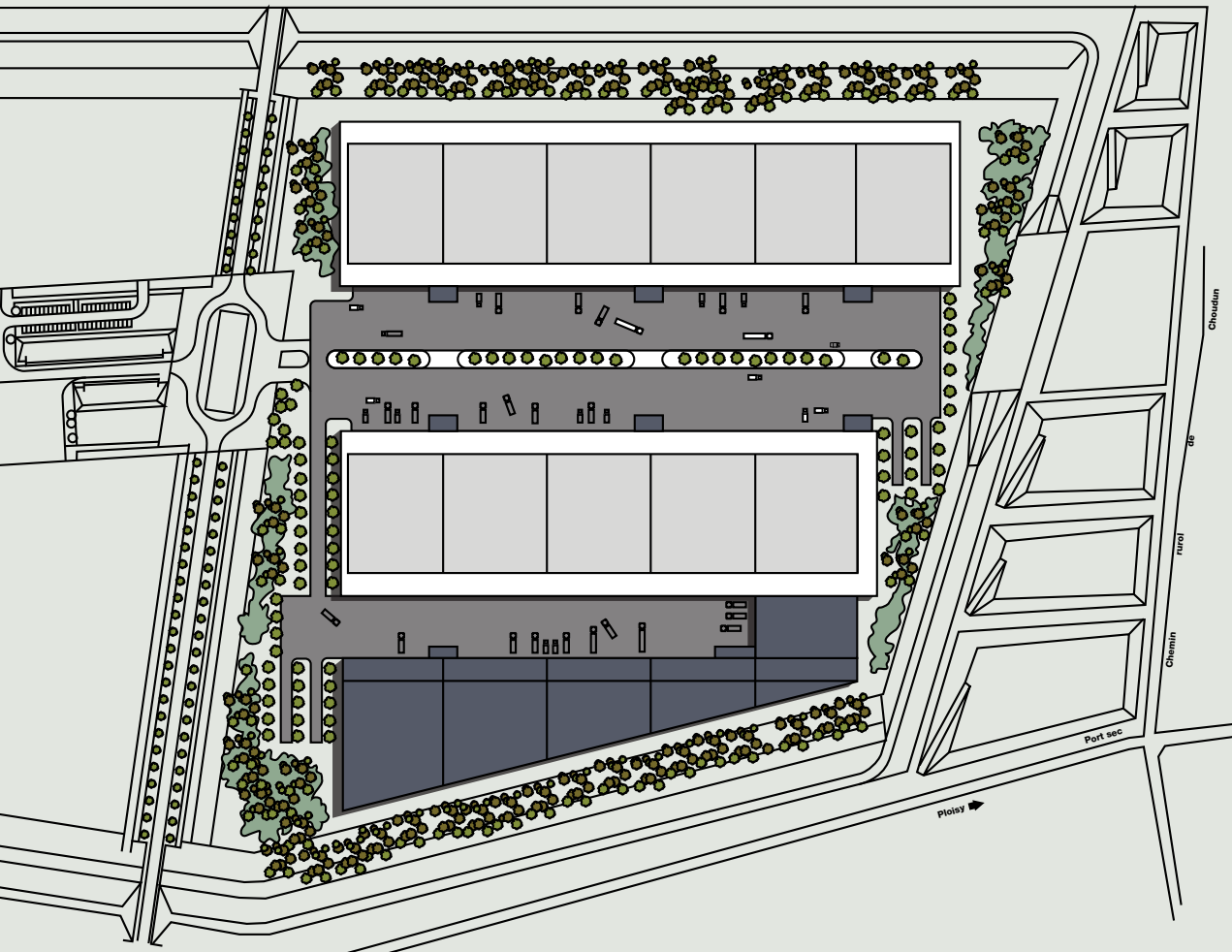

Building	Building (sqm)	Construction Date	Let
North	36,226	2007	19,730sqm
South	42,000	2008	

**Approved ICPE sections**  
North building: 6 cells – ICPE sections 1510/1530/2662/2663 (3 cells already let including one sub-cell of 600sqm 1412 & 1432 already let).  
  
South building: 7 cells for ICPE sections 1510/1530/2662/2663 including one sub-cell 570 sqm for 1412 & 1432.



- Specification**
- State-of-the-art warehouses and offices
  - Offices according to client's requirements
  - Eaves height 10.60m
  - Truck yard width 35m
  - Floor loading 5 tonnes per m<sup>2</sup>
  - Building structure allows stock piling up to 6 pallets high
  - Built according to logistic Grade A technical international standards
  - Constructed with an environmental quality charter (QEB)
  - Sophisticated ditches network system
  - Fire protection network system in place
  - Gas
  - Electricity
  - High speed density ICT network
  - Docks: 1 per 1,000m<sup>2</sup>

- Location benefits**
- Direct access onto Highway No. 2
  - Ideally located in Ploisy with an employment pool of 100,000 people
  - Assistance with recruitment and training via Soissonnais Regional Council
  - Favourable tax climate
  - Professional tax exemption and subsidy package
  - International team of real estate consultants at your disposal
  - Serves Paris region in less than 45 minutes by road
  - Serves other key regions avoiding traffic around Paris
  - Efficient and free road network (2x2)
  - Le Plateau area developed by Soissonnais Council







## Table of Distances

32 km -	Laon
38 km -	Compiègne
57 km -	Reims
61 km -	Saint Quentin
70 km -	Charles de Gaulle Airport

85 km -	Roissy (Ile de France)
100 km -	Paris
167 km -	Lille
173 km -	Belgian border
255 km -	Calais

BUILDER :



ISE Developments is part of the ISE Group, a private property company specialising in the acquisition of logistics warehousing. The company is a leading developer of bespoke distribution facilities with a pan-European network of properties. It has formed a joint venture with Urban Real Estate and together they have created the concept of Geovia, a brand that stands for quality sustainable logistics platforms in strategic locations across Europe.

## ISE Developments

Kansallis House  
1, place de L'Etoile,  
L -1479  
Luxembourg  
+352 24 69 99

[www.industrial-securities.eu](http://www.industrial-securities.eu)  
[info@industrial-securities.eu](mailto:info@industrial-securities.eu)



**From Paris:** Take the A1 (Sarcelles – Charles de Gaulle – Lille), then follow the A104 (Soissons – Parc d'Expositions). At Aulnay-sous-Bois, follow the N2 to Soissons.

**From the North:** Take the A2/E19 (Denain – Lille – Paris). At Denain, follow the A26 to Lyon. Take exit 13 to Laon/Soissons and then follow the D1 to Château Thierry/Soissons.

Notice is given that the information contained in this brochure and the opinions provided are intended to be for general guidance purposes only and do not constitute, nor constitute part of, an offer or contract. All such information and opinions are given in good faith and are believed to be correct but should not be relied upon as statements or representations of fact.

The reader should be aware of the codes of leasing practice that exist in the various European jurisdictions and it is strongly recommended that you seek professional advice from a qualified surveyor, solicitor or notary before agreeing or signing a business tenancy agreement.



Geovia is a trademark for developments that comply with the specifications of the QEB (Qualité Environnementale des Bâtiments) and aims to harmonise the relationship between construction and environment.  
[www.geovia.fr](http://www.geovia.fr)

CBRE +33(0)153 643 630

Entrepôt On Line +33(0)344 063 920

[www.le-plateau.eu](http://www.le-plateau.eu)